

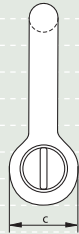

G-4161

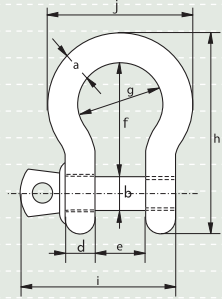

## Green Pin® Standard Shackles

### bow shackles with screw collar pin

- **Material** : bow and pin high tensile steel, Grade 6, quenched and tempered
- **Safety Factor** : MBL equals 6 x WLL
- **Standard** : EN 13889 and meets performance requirements of US Fed. Spec. RR-C-271 Type IVA Class 2, Grade A
- **Finish** : hot dipped galvanized
- **Temperature Range** : -20°C up to +200°C
- **Certification** : at no extra charges this product can be supplied with a works certificate, certificate of basic raw material, manufacturer test certificate and/or EC Declaration of Conformity

working load limit	diameter bow	diameter pin	diameter eye	width eye	width inside	length inside	width bow	length bow	length bolt	width	weight each
tons	a mm	b mm	c mm	d mm	e mm	f mm	g mm	h mm	i mm	j mm	kg
0.33	5	6	12.5	5	9.5	22	16	41	31	28	0.02
0.5	7	8	17	7	12	29	20	54	40	37	0.05
0.75	9	10	21	9	13.5	32	22	61	49	42	0.1
1	10	11	23	10	17	36.5	26	71	56	49	0.14
1.5	11	13	26	11	19	43	29	80	68	54	0.19
2	13.5	16	34	13.5	22	51	32	91	76	63	0.36
3.25	16	19	40	16	27	64	43	114	93	79	0.63
4.75	19	22	47	19	31	76	51	136	107	94	1.01
6.5	22	25	53	22	36	83	58	157	123	107	1.5
8.5	25	28	60	25	43	95	68	176	141	124	2.21
9.5	28	32	67	28	47	108	75	197	158	137	3.16
12	32	35	74	32	51	115	83	218	176	154	4.31
13.5	35	38	80	35	57	133	92	240	192	170	5.55
17	38	42	89	38	60	146	99	262	208	183	7.43
25	45	50	104	45	74	178	126	314	250	226	12.84
35	50	57	111	50	83	197	138	358	281	250	18.15
42.5	57	65	134	57	95	222	160	414	321	287	26.29
55	65	70	145	65	105	260	180	463	355	329	37.6

In inch

working load limit	diameter bow	diameter pin	diameter eye	width eye	width inside	length inside	width bow	length bow	length bolt	width	weight each
tons	a inch	b inch	c inch	d inch	e inch	f inch	g inch	h inch	i inch	j inch	lbs
0.33	3/16	1/4	1/2	3/16	3/8	7/8	5/8	1 5/8	1 1/4	1 1/8	0.05
0.5	1/4	5/16	11/16	9/32	1/2	1 5/32	25/32	2 1/8	1 9/16	1 1/2	0.11
0.75	5/16	3/8	13/16	11/32	17/32	1 9/32	7/8	2 3/8	1 15/16	1 11/16	0.22
1	3/8	7/16	29/32	3/8	11/16	1 7/16	1	2 25/32	2 3/16	1 15/16	0.3
1.5	7/16	1/2	1 1/32	7/16	3/4	1 23/32	1 5/32	3 5/32	2 11/16	2 1/8	0.42
2	1/2	5/8	1 11/32	17/32	7/8	2	1 9/32	3 19/32	3	2 1/2	0.79
3.25	5/8	3/4	1 19/32	5/8	1 3/32	2 17/32	1 23/32	4 1/2	3 11/16	3 1/8	1.38
4.75	3/4	7/8	1 7/8	3/4	1 1/4	3	2	5 11/32	4 3/16	3 23/32	2.22
6.5	7/8	1	2 3/32	7/8	1 7/16	3 9/32	2 9/32	6 5/32	4 13/16	4 3/16	3.31
8.5	1	1 1/8	2 11/32	1	1 23/32	3 3/4	2 11/16	6 29/32	5 9/16	4 7/8	4.86
9.5	1 1/8	1 1/4	2 5/8	1 1/8	1 7/8	4 1/4	2 15/16	7 3/4	6 3/16	5 3/8	6.97
12	1 1/4	1 3/8	2 29/32	1 9/32	2	4 17/32	3 9/32	8 9/16	6 29/32	6 1/32	9.49
13.5	1 3/8	1 1/2	3 5/32	1 3/8	2 1/4	5 1/4	3 5/8	9 7/16	7 9/16	6 11/16	12.24
17	1 1/2	1 5/8	3 1/2	1 17/32	2 11/32	5 3/4	3 29/32	10 5/16	8 3/16	7 3/16	16.37
25	1 3/4	2	4 1/8	1 25/32	2 29/32	7	4 15/16	12 11/32	9 13/16	8 29/32	28.31
35	2	2 1/4	4 11/32	1 31/32	3 9/32	7 3/4	5 7/16	14 3/32	11 3/32	9 13/16	40.01
42.5	2 1/4	2 9/16	5 9/32	2 1/4	3 3/4	8 3/4	6 9/32	16 5/16	12 5/8	11 5/16	57.96
55	2 1/2	2 3/4	5 3/4	2 9/16	4 1/8	10 1/4	7 3/32	18 1/4	14	12 15/16	82.89



**DNV**

TYPE APPROVED PRODUCT  
CERTIFICATION NOTE 2.2-1  
CERTIFICATE NO. S-4208

